

# Charging Pile Energy Management System Solution

In recent years, in response to global warming and climate change caused by greenhouse gas emissions, major countries have focused on promoting electric vehicles to replace traditional fuel vehicles. And the construction of charging piles is very important in the promotion of new energy vehicles. Therefore, a large number of charging pile projects have emerged around the world.

Single phase and three phase AC, DC energy meters complies with the corresponding IEC standards and can be used in all kinds of AC and DC charging piles to realize charging energy measurement, and can transmit electrical parameters in real time through communication.

## Structure

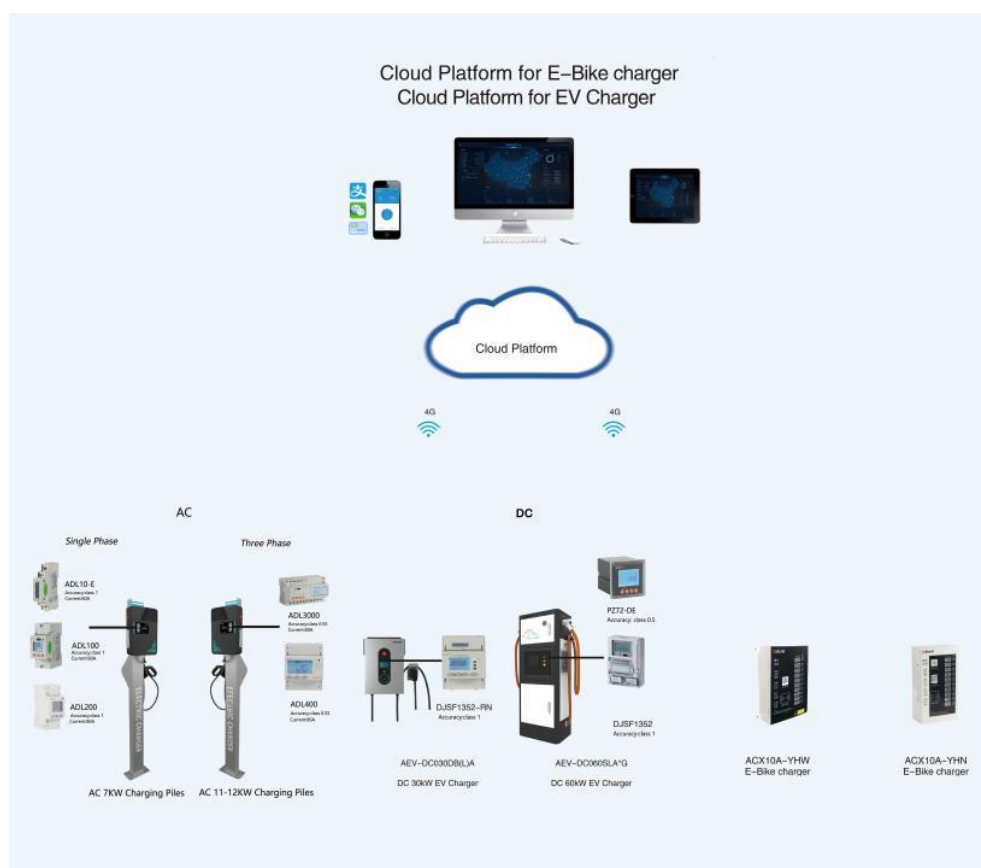

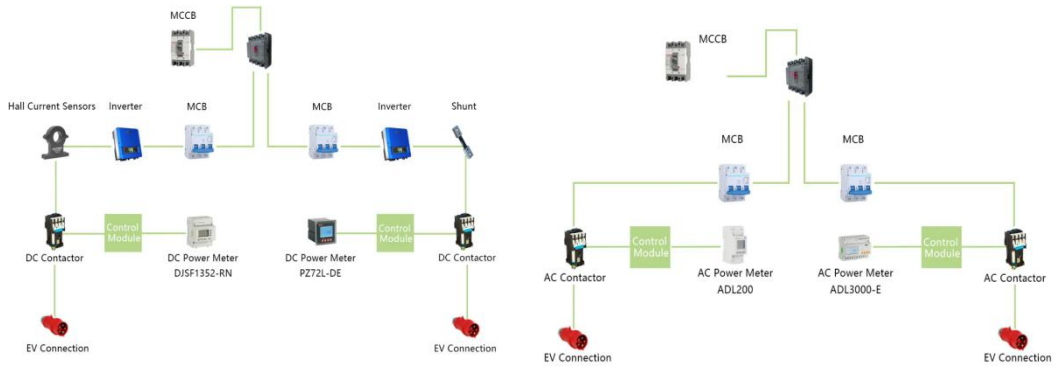

### EV Charger 11-22kw



### EV Charger 11-22kw



### EV Charger 7kw or Below



# Main Functions

It can measure and display electrical parameters such as voltage, current, power, energy, and support RS485 communication and electric energy pulse output.

## 1. Accuracy

Energy Accuracy: Class 0.5S or Class 1

## 2. Optional Configuration

Optional multi tariff.

## 3. Certificate

With CE or IEC certified.

# Product selection

## ADL10-E Single Phase Electric Energy Meter

- AC 220V
- 10 (60) A
- RS485, MODBUS-RTU
- LCD display
- kWh Class 1, Kvarh Class 2
- U、I、P、Q、S、PF、kWh、kvarh





### ADL100-ET Single Phase Multi-function Energy Meter

- AC220V
- 10 (60) A, 20 (100) A
- RS485(MODBUS-RTU)
- Set parameters
- LCD display
- kWh Class 1

### ADL200 Din Rail Energy Meter

- AC220V
- $3 \times 10(80)A$
- RS485(MODBUS-RTU)
- Set parameters
- LCD display
- kWh Class 1



### ADL400 Din Rail Energy Meter

- AC220V
- $3 \times 1(6)A, 3 \times 10(80)A$
- RS485(MODBUS-RTU)
- Set parameters
- LCD display
- kWh Class 0.5
- kWh Class 0.5S, kWh Class 2



### ADL200 Din Rail Energy Meter

- AC220V
- $3 \times 10(80)A$
- RS485(MODBUS-RTU)
- Set parameters
- LCD display
- kWh Class 1



### ADL3000-E Three Phase Multi-function Energy Meter

- AC  $3 \times 220/380V$ ,  $3 \times 380V$ ,  $3 \times 57.7/100V$ ,  $3 \times 100V$
- $3 \times 1(6)A$ ,  $3 \times 10(80)A$
- U、I、P、Q、S、PF、kWh、kvarh
- RS485(MODBUS-RTU)
- LCD display
- Frozen data
- kWh Class 0.5S, kvarh Class 2

### PZ72(L)-DE DC Energy Meter

- Measure voltage, current, power, forward and reverse power in DC system
- Local display
- RS485(MODBUS-RTU)
- Set parameters
- DI/DO, Relay alarm output





### DJSF1352-RN rail-mounted DC power meter

- RS485 communication interface
- Supports Modbus-RTU protocol
- Relay alarm output and digital input function
- Set the ratio, alarm, and communication through the meter panel keys according to different requirements

AHKC-E Hall sensor  
Measurement  
AC, DC, pulse and other complex current



# About Acrel



Acrel Co., Ltd.[stock code: 300286.sz] is founded in 2003, a high-tech enterprise integrates R&D, production, sales and service, since its establishment, it committed to provide users with energy efficiency management and power security system solutions. Acrel Electric has a complete production line from cloud platform software to sensors. Until now, more than 10,000 sets of various solutions are running all over the country.

## Workshop



## Contact

### **Jiangsu Acrel Electrical Manufacturing Co., LTD.**

No.5 Dongmeng Road, Nanzha Street, Jiangyin City, Jiangsu Province, China.

Tel:0086 0510--86179966

Fax:0086 0510--86179975

Email:sales01@email.acrel.cn

Mobile Phone: 0086 18860990013

Whatsapp: 0086 18860990013

Skype: sales01@email.acrel.cn